



REGAL  
— STUDENTS —



## 5 Elgar Bretts Court

16 Gordon Road, Canterbury, CT1 3QU

£1,800 PCM



STUDENT ACCOMODATION 24-25

- FOUR DOUBLE BEDROOM STUDENT HOUSE CLOSE TO CHRISTCHURCH UNIVERSITY AND CITY CENTRE
- TWO BATHROOMS (one en-suite)
- Modern/stylish accommodation
- Kitchen with dishwasher/ washing machine
- Allocated parking for one car
- Half rent for July/Aug
- Bill packages are available through a third party company. Please contact us direct for a quote.



## Area Map



## Floor Plans

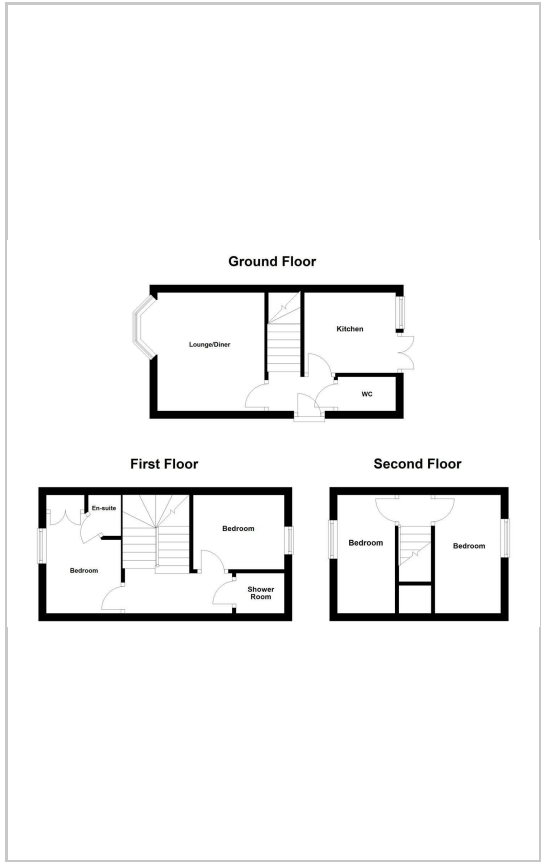

## Energy Efficiency Graph

Energy Efficiency Rating		
	Current	Potential
<i>Very energy efficient - lower running costs</i>		
(92 plus) <b>A</b>		
(81-91) <b>B</b>		
(69-80) <b>C</b>		
(55-68) <b>D</b>		
(39-54) <b>E</b>		
(21-38) <b>F</b>		
(1-20) <b>G</b>		
<i>Not energy efficient - higher running costs</i>		
<b>England &amp; Wales</b>	EU Directive 2002/91/EC	

These particulars, whilst believed to be accurate are set out as a general outline only for guidance and do not constitute any part of an offer or contract. Intending purchasers should not rely on them as statements of representation of fact, but must satisfy themselves by inspection or otherwise as to their accuracy. No person in this firm's employment has the authority to make or give any representation or warranty in respect of the property.

57 Castle Street, Canterbury, Kent, CT1 2PY  
 Tel: 01227 767200 Email: lettingssales@regal-estates.co.uk